



# TOXIC GAS TRANSMITTER MODEL TX-3350Exp-E-D

- ✚ For Non-adsorption gases
- ✚ Exd II CT6 (CNACL)
- ✚ Electrochemical cell
- ✚ NEMA 4X (IP65) enclosure
- ✚ Plug-in and disposable sensor
- ✚ Non-intrusive



For the detection of Non-adsorption gases (like H<sub>2</sub>, CO, PH<sub>3</sub> etc.), the model TX-3350Exp-E-D transmitter is available. In this model, the sensor is enclosed in an explosion proof housing and installed together with the flame arrestor. The entire unit is explosion proof, to be used in hazardous area (Exd II CT6) . With the elimination of a separated sensor housing and a safety barrier, the TX-3350Exp-E-D transmitter offers a system of simple configuration. The transmitter is equipped with zero and span adjustments accessible, allowing one-man calibration without communication with control room personnel.

## Measuring gas name and range

\* 3 or 4 digits number which is same as sensor model number.

## Sensor GS-[\*]EP

Sensor model	Gas name	Range (ppm)	Sensor model	Gas name	Range (ppm)
GS- 250EP	H <sub>2</sub> S	0-50	GS-2150EP	IPA	0-600
GS- 550EP	SO <sub>2</sub>	0-6	GS-2250EP	EtO	0-150
GS-1100EP	O <sub>2</sub>	0-25%	GS-3050EP	TEOS	0-30
GS-1250EP	CO	0-75	GS-3355EP	VCM	0-200
GS-1555EP	H <sub>2</sub>	0-4000	GS-5050EP	PH <sub>3</sub>	0-1
GS-1790EP	NO	0-100	GS-5050EP	SiH <sub>4</sub>	0-15



Above table indicates typical sensor model, gas name and standard range.

When you need different gases information, feel free to contact Bionics Instrument group below.

## Specifications

Transmitter model	TX- 3350ExP-E-D
Detecting principle	Electrochemical
Response	T60 < 30 sec.
Accuracy	± 30 % of alarm setting amount
Display	3 1/2 Digital
Sampling style	Diffusion, Continuous, Single point
Mounting style	Wall mount
Operating temperature	0 ~ 40°C
Analog Output	4-20 mA DC
Explosion-proof	Exd IICT6 (CNACL)
Power Requirement	24 V DC
Power Consumption	Approx. 3W
Dimension(approx.)	170(W) × 235(H) × 115(D) mm
eight	Approx. 3.5 kg

## Dimension

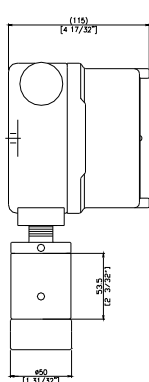

TX- 3350 ExP-E-D

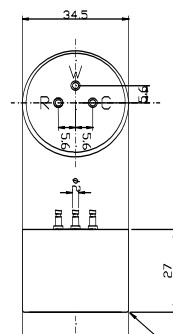
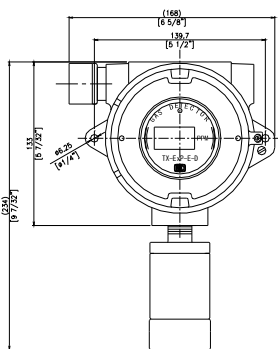

GS-[ \* ] EP

\*We reserve the right to change specifications without notice.

### Bionics Instrument Co., Ltd.

6-1254-2 Shimizu, Higashi-yamato, Tokyo 207-0004, Japan.  
TEL: +81-42-561-4856 FAX: +81-42-565-3950  
E-mail: [trade@bionics-japan.co.jp](mailto:trade@bionics-japan.co.jp)

### Bionics Instrument Europe B.V.

Maxwellstraat 7, 1704 SG Heerthugowaard, The Netherlands.  
TEL: +31-72-576 5630 FAX: +31-72-572 1818  
E-mail: [info@bionics.net](mailto:info@bionics.net)

### PureAire Monitoring Systems Inc.

557 Capital Drive, Lake Zurich, Illinois 60047, USA.  
TEL: +1-847-726-6000 FAX: +1-847-726-6051  
Toll Free: 888-788-8050 E-mail: [pureaire@dls.net](mailto:pureaire@dls.net)

### Global Bionics Trading Corp.

No. 9, Lane 23, Guang-Ming 1<sup>st</sup> Rd., Chu-Pei City, Hsinchu Shien, Taiwan  
R.O.C. TEL: 886-3-553-8986 FAX: 886-3-553-8987  
E-mail: [gbionics@ms56.hinet.net](mailto:gbionics@ms56.hinet.net)